

LESTAGRI EUROMASSE

Specialists in the design of innovative and versatile
cast-iron and steel ballast weights
in monobloc and evolutive versions from 250 kg to 2,850 kg
... and much more!



ALL OUR PRODUCTS
ARE MANUFACTURED IN
FRANCE

Tel. +33 (0)5 82 81 97 50
lestagri.euromasse@gmail.com

euromasse.com
lestagri.fr

SUMMARY

LESTAGRI STEEL/CAST-IRON BALLAST WEIGHTS 3

Monobloc and scalable from 250 kg to 2,400 kg 4
Accessoires 7

EUROMASSE CAST-IRON BALLAST WEIGHTS 9

Monobloc version 850 kg and 1,400 kg 9
Evolutive ballast weights from 600 kg to 2,850 kg 12
Accessories 18

BUMPERS 21

Our complete bumper solution 21
ECO-BUMPER 24

NEW! WITH DIRECTION INDICATORS!

IMPLEMENT TRACTING REAR BALLAST WEIGHTS 25

Monobloc and evolutive rear ballasts 26
Rear ballasts LESTRACTION from 1,900 kg to 2,500 kg 28

SUMMARY OF PART NUMBERS 31



Shaft and three-point pin supplied, the ballast weights are ready to be mounted upon delivery.

Three-point bracket mounted in mortise and tenon

Clevis hitch properly positioned

CAT 3.2 ball joints included

U-bolt (clevis) coupling

Threaded holes for bumper option

2 coupling heights from 900 kg ballast weights

300 kg, 400 kg or 600 kg add-on modules

Fitting guide and rear stop for module addition: easy to slot into place



4 colours available + Customization

Designed to match the tractor's style, each ballast being compact in size and having a reduced overhang (see p.31)

Optional grab bar, for coupling without push bar (see p.7)



Available with storage box



MONOBLOC



Two monobloc ballast weights adaptable to vineyard and orchard tractors, front or rear in cat. 1, with a double hitch in cat. 3/2 for standard tractors. **Compatible with the special FENDT series V accessory** (see page 8).

EVOLUTIVE



PACK 800 KG
Part No.: MBE5300PFB

PACK 1,100 KG
Part No.: MBE5600PFB



500 kg ballast weight with integrated storage box: large 125 L volume, ideal for storing tools, grease guns, cans, accessories, etc. **with locking system:** possibility of adding a padlock.

Inside box dimensions: Approx. length: 105 cm x height: 40 cm x depth: 30 cm



PACK 900 KG
Part No.: MBE6300B

PACK 1,200 KG
Part No.: MBE6600B



PACK 1,200 KG
Part No.: MBE9300B

PACK 1,500 KG
Part No.: MBE9600B

**900 KG EVO BALLAST
WITH TOOLBOX**

Part No.: MBE900PFA



MODULE 300 KG

Part No.: MD300B



MODULE 600 KG

Part No.: MD600B



PACK 1,200 KG

Part No.: MBE9300PFB

PACK 1,500 KG

Part No.: MBE9600PFB



900 kg ballast weight with integrated front storage box: large volume of approx. 140 l ideal for storing tools, grease guns, cans, accessories, etc. **+ locking system:** possibility of adding a padlock.

**1,200 KG
EVO BALLAST**

Part No.: MBE1200A



300 KG MODULE

Part No.: MD300B



600 KG MODULE

Part No.: MD600B



PACK 1,500 KG

Part No.: MBE12300B

PACK 1,800 KG

Part No.: MBE12600B

**1,400 KG
EVO BALLAST**

Part No.: MBE1400A



400 KG MODULE

Part No.: MD400B



600 KG MODULE

Part No.: MD600B



PACK 1,800 KG

Part No.: MBE14400B

PACK 2,000 KG

Part No.: MBE14600B

**1,800 KG
EVO BALLAST**

Part No.: MBE1800A



400 KG MODULE

Part No.: MD400B



600 KG MODULE

Part No.: MD600B



PACK 2,200 KG

Part No.: MBE18400B

PACK 2,400 KG

Part No.: MBE18600B

All our monobloc and evolutive ballasts are available in 4 colours

- ✓ CUSTOMIZABLE to the dealership's logo.
- ✓ SAFETY & SECURITY: ball coupling (ball joints supplied) for maximum reliability, and reflective stripes for maximum visibility.
- ✓ EVOLUTIVE thanks to the adaptation of 300 kg, 400 kg or 600 kg modules.
- ✓ ALIGNMENT is very easy, in backward mode for better visibility thanks to an interlocking range of 25 cm.
- ✓ COMFORTABLE: With the 'grab bar' accessory, coupling is carried out without push bar and without getting off the tractor, even for modular ballasts.
- ✓ FUNCTIONAL with 2 coupling heights for ballasts from 900 kg to 2,400 kg.
- ✓ COMPACT: From the ball joint shaft, the offset is reduced thanks to the density of the material.
For example: For the 1,500 kg pack (900 kg + 600 kg) = offset of 400 mm. For the 1,800 kg pack (1,200 kg + 600 kg) = the offset is 470 mm.
- ✓ ATTRACTIVE design that blends perfectly with the new tractor superstructures, 4 colours available depending on the tractor chassis (no extra charge).
- ✓ EXCELLENT value for money.
- ✓ NUMEROUS compatible ACCESSORIES: ballast support interface, tool holder, bumpers, etc.



ACCESSORY: GRAB BAR FOR QUICK COUPLING

Part No.: ACCBAA

All LESTAGRI weights can be fitted with an optional grab bar very easily adaptable to avoid the attachment of the third point without getting off the tractor. Get maximum working comfort!



ACCESSORY: LESTAGRI BALLAST-MOUNTED TOOL HOLDERS

If required, we can adapt **a tool holder interface** to LESTAGRI cast-iron and steel ballasts.

This accessory allows to carry different tools in 3 places (spare parts, trowels, buckets, etc.).

Features two automatic Cat. 2 hooks.



Part No.: ACCCR



ACCESSORY: ADAPTATION INTERFACE ON BALLAST HOLDER

Allows LESTAGRI ballasts to be adapted **to original John Deere or CLAAS ballast holders**. Steel accessory featuring automatic coupling hooks.

6 weights are possible: 500 kg / 600 kg / 800 kg / 900 kg / 1,000 kg / 1,200 kg.

3 adaptation options:

- ✓ Suspending the counterweight;
- ✓ Using handling forks;
- ✓ Without getting off the tractor, by deactivating the suspension.

Part No.: ACCPM



ACCESSORY: SPECIAL FENDT VINEYARD ADAPTATION INTERFACE



■ **THE SPECIAL FENDT VINEYARD INTERFACE** allows the ballast to be fitted closer to the tractor, thus reducing the front overhang in narrow tracks, making it easier to turn in vine rows. The assembly is realised with 4 shafts supplied.

Allows you to pick up the ballast weight without getting off the tractor, as it is fitted with automatic couplings and without attaching a push bar.

Can be used for equipment attached to the front with a very short push bar (leaf remover, lopping machine, pre-pruner or other three-point implements). Makes the unit more compact and allows to position the weight on the rear lift.

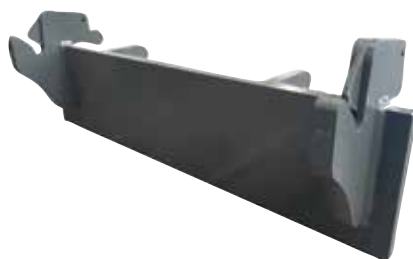

100% CAST-IRON MONOBLOC WEIGHTS

Watch our videos
on our websites
euromasse.com
lestagri.fr

The monobloc ballast weights are **compatible at the front and rear** thanks to their **clevis coupling and compact design**, allowing to carry up to 3 tonnes and tow equipment weighing up to 12 tonnes to gain maximum adherence. (see p.27 for «traction frame accessory»).

A truly versatile weight!

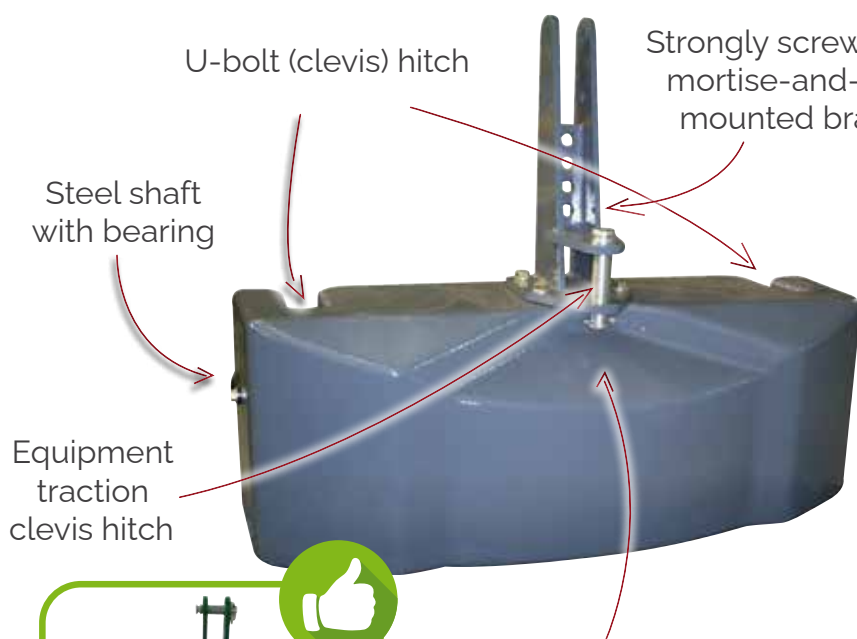

Clearance for the passage
of a drawbar when towing
implements
up to 12 tonnes



LES MONOBLOCS 100 % FONTE

Watch our videos
on our websites
euromasse.com
lestagri.fr

- ✓ **QUALITY:** 100% cast-iron for high strength.
- ✓ **RELIABILITY** thanks to the clevis coupling: the shafts are mounted on pins in the cast-iron block for maximum resistance.
- ✓ **HIGH STRENGTH** of the 3-point steel bracket, mortise-and-tenon mounted and screwed into inserts cast into the cast-iron block for exemplary reliability (CTIF* standard).
- ✓ **EASY ADAPTATION** from the ball-and-socket joints in the recesses at the rear of the cast-iron block (clevis hitch). The opening is bevelled to facilitate insertion of the lifting arms. Thanks to the «grab bar» accessory the ballast can be connected to the tractor without having to get off the vehicle (see p.11).
- ✓ **VERSATILE:** Compatible with front and rear lift arms and some original ballast carriers (with the «interface» accessory presented on p.11).
- ✓ **FUNCTIONAL** with the adaptation of the «equipment traction frame» accessory for better adherence and higher productivity. Traction of semi-mounted or trailed equipment weighing up to 12 tonnes (safety test carried out at coefficient 2, see page 27).
- ✓ **COMPACT:** Maximum offset of 27.5 cm for the 850 kg ballast, and 37.5 cm for the 1,400 kg ballast weight.
- ✓ **DESIGN:** regular fine-grained finish. The sober and modern design harmonises with today's tractors.
- ✓ **COMPLETE:** supplied with three-point bracket, three-point shaft and pin, 2 clevis pins and category 3.2 coupling ball joints.

*CTIF: Centre technique des industries de la fonderie (Technical Center for Foundry Industries)

VERSATILE ON REAR LIFT (Details on page 27)

- ✓ Three-point hitch with drawbar for towed equipment, securely bolted to steel inserts cast into the cast-iron block.
- ✓ Carrying weight of implements in 3 pts up to 3 tons.
- ✓ Traction of equipment weighing up to 12 tons.
- ✓ Equipment traction frame accessory:
 - A-Version for semi-mounted equipment ;
 - B-Version for trailed equipment.



(Details on page 27)

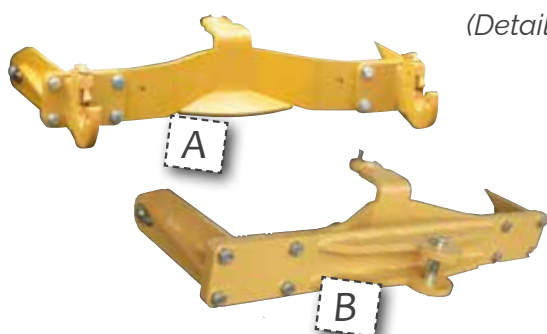

ACCESSORIES FOR 100% CAST-IRON MONOBLOCS

✓ *Quick-release grab bar*

All Euromasse ballast weights can be fitted with an **optional grab bar** that can be easily adjusted to prevent the third point from hooking. Attaching and detaching of the ballast without leaving the tractor.



✓ *JOHN DEERE ballast carrier / equipment carrier interface*

Enables adaptation of a Euromasse ballast (monobloc and evolutive up to 1,400 kg) to the original ballast holder.

Steel accessory featured with **automatic coupling hooks**.

3 adaptation possibilities:

- Suspension of the weight ;
- Using handling forks ;
- Without leaving the tractor, by deactivating the suspension.



The user easily adapts or removes counterweights without physical efforts.

✓ *Adaptation on SETRA plate*

The interface allows Euromasse ballast weights to be adapted to SETRA plates.

The counterweight can be reused for the front/rear lift. Only small offsets at the front thanks to cast-iron density.

Three interface models for adaptation to SETRA plates:

- SETRA 600 interface: for EVO ballasts of 600 kg to 1,000 kg / 1,200 kg.
- SETRA 800 interface: for EVO ballasts of 800 kg to 1,200 kg / 1,400 kg, and for monobloc ballasts of 850 kg and 1,400 kg.
- SETRA 1450 interface: for EVO ballasts of 1,450 kg to 2,850 kg.

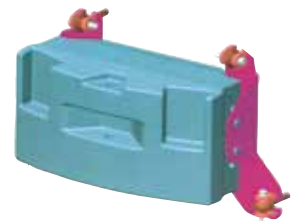

A lifting point is located at the centre of gravity for the suspension of the ballast. Two conical centring plugs, four flip-down flanges on the SETRA plate enable locking.



100% CAST-IRON EVOLUTIVE WEIGHTS

Watch our videos
on our websites
euromasse.com
lestagri.fr

The wide range of our **evolutive range** (3 base weights + front and ventral modules) and various **interlocking possibilities** make it a highly **versatile product**.

Three-point bracket securely screwed into metal inserts cast into the cast-iron (CTIF standard)

Convenient and useful, a closed tool box integrated into the ballast weight (from 800 kg up)

Reliable and robust, the U-bolt (clevis) hitch: shafts are broached in the cast-iron



2 coupling positions for better adaptation (from 1,450 kg)



Easy and comfortable fitting of ballasts without getting off the tractor



Very compact thanks to the density of the cast-iron, higher durability

- ✓ **LARGE CHOICE OF MODULARITY:** from 3 basic weights 600 kg / 800 kg / 1,450 kg more than 13 different weights can be obtained, depending on requirements and tractors.
- ✓ **QUALITY:** 100% cast-iron for density, strength and durability.
- ✓ **RELIABILITY** thanks to the U-bolt (clevis) hitch: the shafts are broached in the cast-iron block and offer a choice of 2 heights (depending on model).
- ✓ **SIMPLIFIED HITCHING** thanks to ball-and-socket joints locked in the recesses at the rear of the cast-iron block (clevis hitch). The opening is bevelled to facilitate insertion of the lifting arms.
- ✓ **STRENGTH** of the three-point bracket mounted in mortise and tenon for outstanding reliability (CTIF* standard).
- ✓ **DESIGN:** regular, subtle and modern fine-grained finish. Many colours available.
- ✓ **COMPLETE:** supplied with three-point bracket, three-point shaft and pin, 2 clevis pins and Cat. 3.2 coupling ball joints. Three-point ball joint supplied from 1,450 kg.

*CTIF: Centre technique des industries de la fonderie (Technical Center for Foundry Industries)

THE ADVANTAGES OF EVOLUTIVE WEIGHTS

✓ Integrated storage box

From 800 kg basic weights: ≈ 15 l.
From 1,450 kg basic weights: ≈ 30 l.



✓ Secure 2-height clevis hitch for maximum versatility:

The U-bolt (clevis) hitch provides a secure fit, breaking is impossible.

Position 1 allows the ballast weight to be positioned as low as possible for better adherence (standard position).

In **position 2**, the rear-mounted weight gives free access to the hook or the swing bar.



✓ Three fitting/interlocking options:

- Additional modules can be fitted like a jigsaw puzzle, without getting off the tractor, without physical effort and with ease. The front ballast weights are lifted, while the belly ballast is taken by moving forward.
- With forks from fork-lift trucks, thanks to perforations/slots on the front modules.
- By suspending the modules using threaded inserts provided at the front of the additional ballast weights.



✓ 4 colors available, other colours on request.



AGCO Grey



CLAAS Grey



J.DEERE Green



Black

600 KG EVOLUTIVE WEIGHT



- ✓ U-bolt (clevis) hitch for greater safety and better adaptation to the tractor.
- ✓ Compatible with front/rear lifting arms and with some original weight supports.
- ✓ **Compact:** 22 cm offset on lifting arm and 30 cm offset on weight support.
- ✓ **Functional, 2 hitch heights** (in rear position, provides ample towbar clearance for towing implements) *see page 26*.
- ✓ Integrated operating platform.
- ✓ Supplied complete with shafts + three-point pin + 2 clevis pins with ball joints, cat. 3.2.

800 KG EVOLUTIVE WEIGHT



- ✓ U-bolt (clevis) hitch for greater safety and better adaptation to the tractor.
- ✓ Integrated tool box with 15 l volume.
- ✓ Compatible with front/rear lift.
- ✓ **Compact** with 33 cm offset.
- ✓ Integrated operating platform.
- ✓ Supplied complete with shafts + three-point pin + 2 clevis pins with ball joints, cat. 3.2.



GET ADDITIONAL BALLAST WEIGHTS: 400 KG AND 600 KG

✓ With the front module **mounting bracket accessory**, option to mount the additional 400 kg and 600 kg modules on the tractor's three-point lifting system.

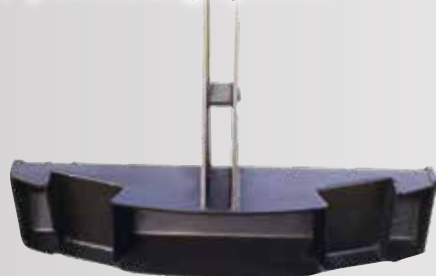

BASIC WEIGHT 1,450 KG

GET UP TO 6 DIFFERENT WEIGHTS, AND MANY MORE WITH ACCESSORIES!



- ✓ 6 ballast weights to be obtained with additional modules.
- ✓ Modular **without getting off the tractor**.
- ✓ Compatible with **front/rear lift**.
- ✓ **Integrated 30 L storage box**, width 65 cm, with its lid.
- ✓ **2 clevis coupling heights**, for an adaptation suitable to the needs.
- ✓ **Compact**: 40 cm offset (ballast weight 1,450 kg).
- ✓ **Greater modularity** thanks to the 'B-type mounting bracket' accessory *see p.18*.
- ✓ **Supplied** with shafts + three-point pin + 4 clevis pins with their Cat. 3.2 ball joints.



1,450 KG EVO
Part No.: E031114500



PACK 1,850 KG
Part No.: E031118500



PACK 2,050 KG
Part No.: E031120500



PACK 2,250 KG
Part No.: E031122500



PACK 2,450 KG
Part No.: E031124500



PACK 2,850 KG
Part No.: E031128500



EVOLUTIVE WEIGHT 1,450 KG



PACK 1,850 KG



PACK 2,050 KG



PACK 2,250 KG



PACK 2,450 KG



PACK 2,850 KG

ACCESSORIES FOR OUR MONOBLOC RANGE

✓ *Traction frame for semi-mounted implements (A)*

Adjustable in cat. 2 and cat. 3 by simply reversing the hooks. Ballasting is simplified with automatic keying, accommodates 2-point hitches for semi-mounted implements (Cover Crop, disc harrow, semi-direct, etc.) (see p.27).



✓ *Traction frame for trailed equipment (B)*

Allows ring-type implements to be fitted, for better adherence and productivity. Traction up to 12 tonnes (see p.27).



ACCESSORIES FOR OUR EVOLUTIVE RANGE

✓ *Front module mounting bracket A and B**

- ✓ Allows additional front modules 400 kg-A, 600 kg-A and 800 kg-B to be mounted.
- ✓ Possibility of ballasting 2 tractors with the same ballast weights using the mounting bracket + one evolutive pack.
- ✓ Sturdiness thanks to mortise and tenon construction and clevis hitching.
- ✓ Compatible with front and rear lifting arm (720 mm and 880 mm centre distance).

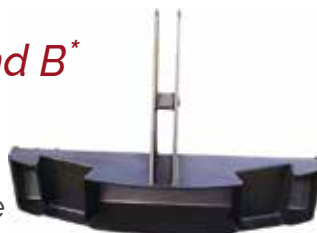

✓ *Tool/equipment holder / frontal support** with automatic hooks*

- ✓ Versatile: allows different tools (reserves, buckets, weights, etc.) to be carried
- ✓ Features two automatic hooks.



«Gain maximum modularity»

- ✓ Even more flexibility: combine 2 weights to obtain up to 26 different weights.

*Version A for front modules 400 kg-A, 600 kg-A and version B for front modules 400 kg-B and 800 kg-B.

**For all evolutive ballast weights except 1,450 kg.



✓ *Quick-release grab bar*

All Euromasse weights can be fitted with an optional grab bar, which can be easily adjusted to prevent the third point from hooking. Attaching and detaching the ballast weight without leaving the tractor.



✓ *JOHN DEERE ballast carrier / tool holder interface*

Enables adaptation of an Euromasse (monobloc and evolutive up to 1,400 kg) to the original ballast carrier. Steel accessory featured with automatic coupling hooks.

3 adaptation possibilities:

- Suspension of the counterweight ;
 - Using handling forks ;
 - Without leaving the tractor, by deactivating the suspension.
- The user easily fits or removes counterweights without physical efforts.



✓ *Adaptation on SETRA plate*

The interface allows Euromasse ballast weights to be adapted to SETRA plates, and the counterweight to be reused for the front/rear lift. Low front-end offset thanks to cast-iron density.

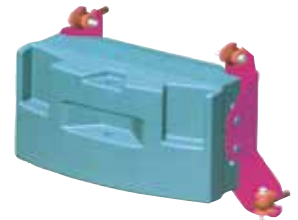

Three interface models for adaptation to SETRA plates:

- SETRA 600 interface: for EVO ballasts of 600 kg to 1,000 kg / 1,200 kg.
- SETRA 800 interface: for EVO ballasts of 800 kg to 1,200 kg / 1,400 kg, and for monobloc ballasts of 850 kg and 1,400 kg.
- SETRA 1450 interface: for EVO ballasts of 1,450 kg to 2,850 kg.



A lifting point is located at the centre of gravity for the suspension of the ballast. Two conical centring plugs, four flip-down flanges on the SETRA plate enable locking.



SOME PHOTOS - MONOBLOC RANGE



SOME PHOTOS - EVOLUTIVE RANGE



SOME PHOTOS - REAR TRACTION



See all our rear ballast solutions on page 26.

BUMPER

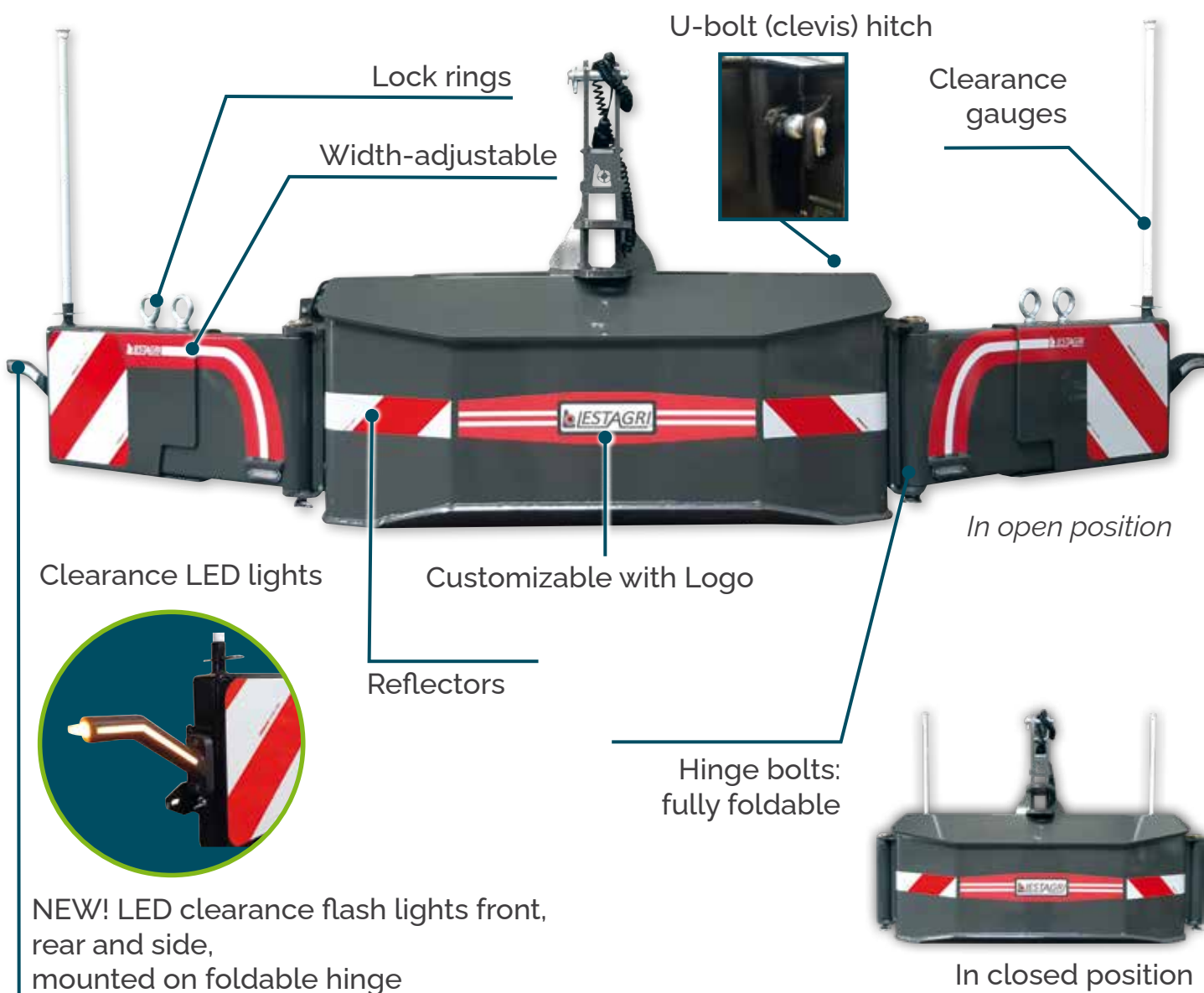

NEW! LED clearance flash lights front, rear and side, mounted on foldable hinge

- ✓ **ADJUSTABLE** in width, according to tractor track, and in height via the lifting system.
- ✓ **COMFORTABLE**: Adjustable without tools, without physical efforts. Ballast weights are evolutive with or without the Bumper.
- ✓ **FOLDABLE** on either side of the ballast weight, depending on requirements and work.
- ✓ **COMPATIBLE** and adaptable ON ALL OUR evolutive BALLASTS.
- ✓ **WEIGHT SELECTION** from 500 kg to 2,850 kg.
- ✓ **COMPLETE**: Supplied with LED lights, red and white reflectors, clearance gauges and direction indicators.
- ✓ **DESIGN** in harmony with the tractor's colour scheme.
- ✓ **CUSTOMIZABLE** with dealership logo on ballast weight.

BUMPER



SAFETY AND DESIGN ON THE ROAD THANKS TO DIRECTION INDICATORS

OPEN:
ROAD USE
for user safety when in the 'open' position



VISIBILITY AND MANOEUVRABILITY IN THE FIELD



CLOSE:

USE AT WORK
for maximum visibility and manoeuvrability in the 'closed' position



ADJUSTABLE ROAD AND WORK POSITION

in only a few seconds, adjustable and foldable, no need of tools, without physical efforts



Pull out the 2 shafts and remove the push bar and store them in their housing.



Unlock and fold the clearance lights, then lock.



Unscrew the 2 threaded rings, then slide the bumper to obtain the smallest possible clearance.



Fold back and secure with the threaded ring.

BUMPER

ADAPTATION TO LESTAGRI STEEL/CAST-IRON BALLAST

Compatible with monobloc and evolutive ballast weights from 500 kg to 2,400 kg



ADAPTATION TO EUROMASSE CAST-IRON BALLAST

Compatible with:

- monobloc ballast weights 850 kg and 1,400 kg,
- evolutive ballast weights from 800 kg to 1,200 kg and 1,400 kg
- evolutive ballast weights 1,450 kg, 1,850 kg, 2,050 kg, 2,250 kg, 2,450 kg, 2,850 kg



ECO BUMPER

ECO-BUMPER: THE ECONOMICAL BUMPER VERSION



Open position

- ✓ **COMFORTABLE:** Adjustable and width-adjustable, without physical efforts. The ballasts are modular, with or without bumper.
- ✓ **COMPACT:** Foldable on either side of the ballast weight, depending on requirements and work.
- ✓ **COMPATIBLE** and adaptable on all our Lestagri and Euromasse ballast weights from 500 kg, either monobloc and evolutive.
- ✓ **COMPLETE:** Supplied with red and white reflectors, clearance gauges and clearance lights.
- ✓ **DESIGN** in harmony with the tractor's colour scheme.
- ✓ **CUSTOMIZABLE** with dealership logo on the weight.
- ✓ **QUALITY:** total weight of 60 kg.



Closed position



REAR BALLAST WEIGHTS

SOLUTIONS FOR ADDING WEIGHT TO TRACTOR'S REAR LIFT

For ballasting in the rear position, we offer 4 possibilities:

- ✓ **EUROMASSE monobloc** ballast weight with or without equipment traction frame.
- ✓ **EUROMASSE evolutive** ballast weight with 2 coupling positions.
- ✓ **The evolutive LESTRACTION** traction ballast weight from 1,900 kg to 2,500 kg.

THE ADVANTAGES OF REAR BALLASTING

- ✓ Replaces wheel ballasts
- ✓ Prevents skidding
- ✓ Reduces tire wear
- ✓ Reduces fuel consumption
- ✓ Improves productivity

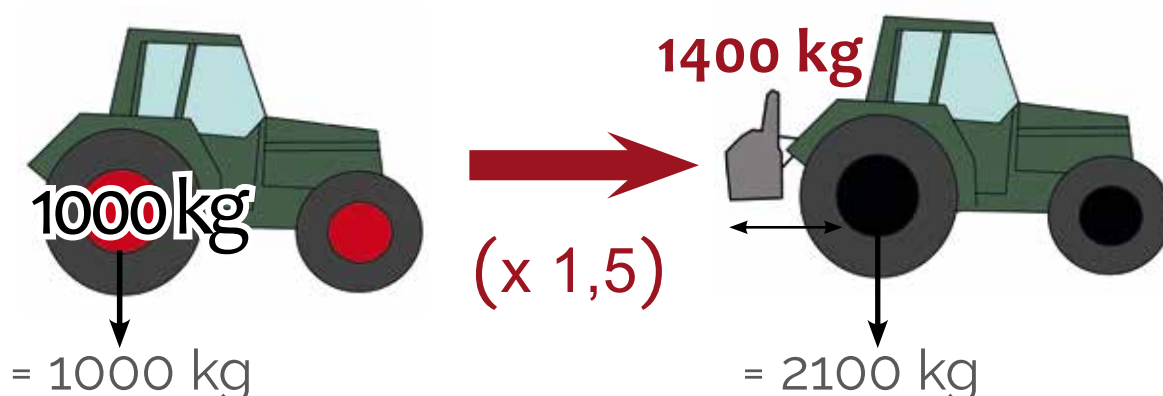

- ✓ The fact that a monobloc ballast is positioned on the rear lift allows, through a lever effect, to multiply the weight (x 1,5) at the rear wheels.

Example:

- The 850 kg monobloc ballast at rear equals approx. 1,300 kg.
- The 1,400 kg monobloc ballast at rear equals approx. 2,100 kg.



REAR BALLAST WEIGHTS

✓ For all implement types, the EUROMASSE - LESTAGRI concept optimizes adherence.

The convergence line (traction line, represented in green on the diagram opposite) should rise slightly towards the tractor under difficult conditions. This process is eased with Euromasse ballast weights and implement traction solutions.

✓ The height of the lift is decisive, and the implement remains solidly anchored in the ground (possible adjustment of the towbar). The tractor's sway bar, often positioned too low (red line in diagram), causes the tractor to slip/skid.

✓ This concept of rear ballast weights for traction provides maximum adherence, total visibility of the equipment and improved turning radius.

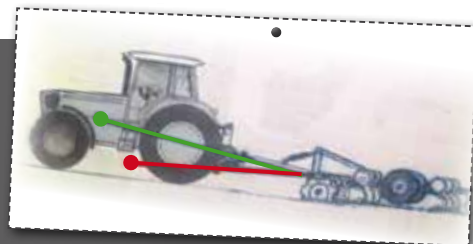

EUROMASSE EVOLUTIVE RANGE

Watch our videos
on our websites
euromasse.com
lestagri.fr

6 ballast weights are possible:

600 kg / 1,000 kg / 1,200 kg / 1,450 kg / 1,850 kg / 2,250 kg.

- ✓ Weights are **modular** to suit requirements.
- ✓ **Replace the wheel ballasts** when towing trailed implements.
- ✓ **Useful at the rear** of the tractor when using a loader.
- ✓ **Largely frees the passage of the towbar**, for simple attachment to the sway bar and tractor hitch, for towing trailed implements.
- ✓ Avoid skidding: tractor adherence.
- ✓ Reduces tire wear and fuel consumption.



REAR BALLAST WEIGHTS

850 KG AND 1,400 KG EUROMASS MONOBLOC RANGE

A versatile three-point towbar:

- ✓ Solidly screwed into steel inserts cast into the cast-iron block.
- ✓ Mortise and tenon construction for outstanding quality, strength and finish.
- ✓ Traction of towbar implements up to 12 tonnes.
- ✓ Ease of use: towbar clearance on slopes and when cornering.



Approved towbar

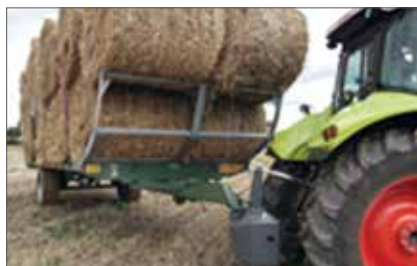

Accessory: A and B traction frames:

- ✓ Flexible: quick installation and removal.
- ✓ Very low centre of gravity = better adherence and increased productivity.
- ✓ Excellent visibility of the implement at work.
- ✓ Versatile: compatible with the front and rear of the tractor.

- ✓ *Adjustable in cat. 2 and cat. 3 by simply inverting brackets/hooks.*

Ballasting is simplified with automatic keying, and accommodates 2-point hitches for semi-mounted implements (Cover Crop, disc harrow, semi-direct, etc).

- ✓ *Traction frame for trailed implements (B)*

allows you to adapt ring mounted implements for better adherence and higher productivity.

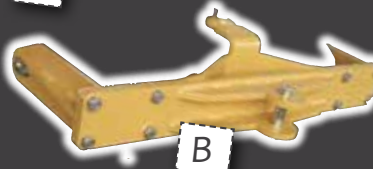

REAR BALLAST WEIGHTS

Watch our videos
on our websites
euromasse.com
lestagri.fr

LESTRACTION: 1 900 KG - 2 500 KG

- ✓ **Evolutive** from 1,900 kg to 2,500 kg, thanks to additional 300 kg ballast weights.
- ✓ Simple, easy and fast, attaches and detaches effortlessly **without tools**.
- ✓ **2 coupling heights** in cat 3 and cat 4 N.
- ✓ Allows to tow **all types of implements**: mounted, semi-mounted and trailed, with or without PTO.
- ✓ **Excellent visibility** of the implements at work, thanks to the density of the counterweight.
- ✓ **Productivity gains**.
- ✓ **Replaces** wheel ballast weights.
- ✓ **Reduces** tire wear.
- ✓ Supplied **complete**, ready to use.
- ✓ **Option: tow bar** and cardan bearing, adjustable height, for trailed implements with PTO.
- ✓ Hitch **for all tractor makes and types**.



REAR BALLAST WEIGHTS

✓ FACING TRACTOR:

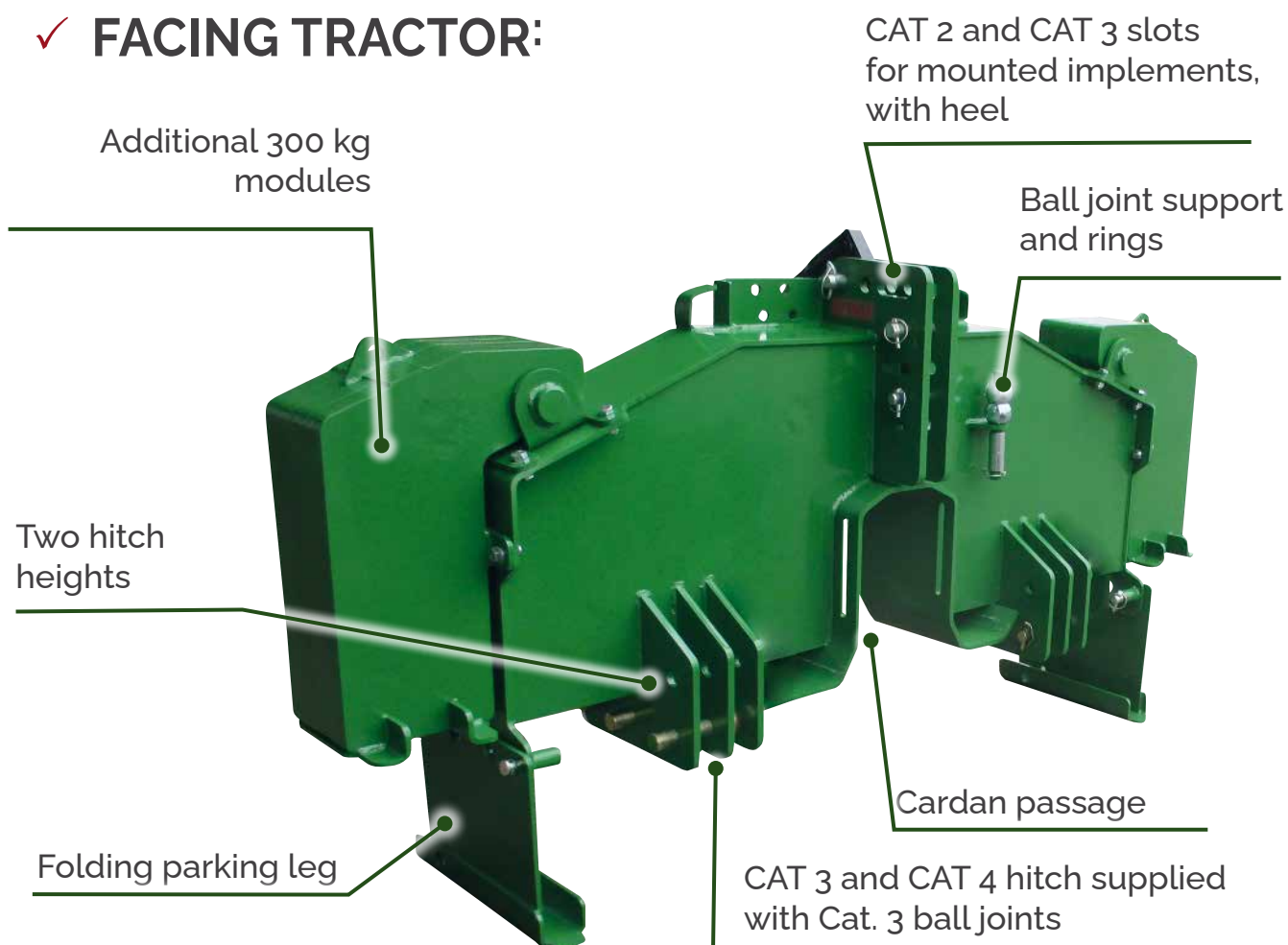

REAR BALLAST WEIGHTS

✓ FACING EQUIPMENT:

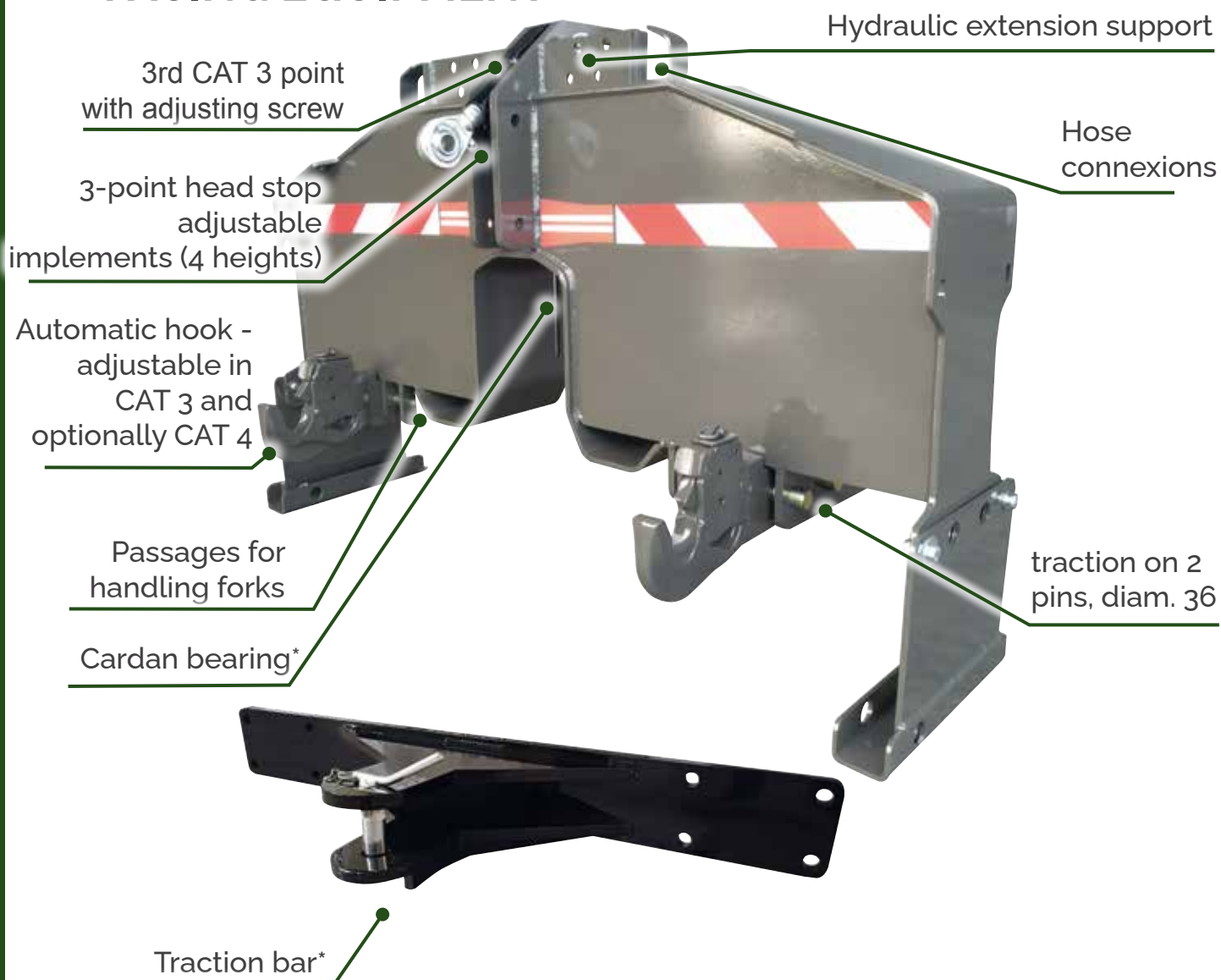

* optional

SUMMARY OF PART NUMBERS

Cast iron and steel ballast weights

Designations	Art. no.	Offset (Overhang)
MONOBLOC 250 kg	MB250A..	280 mm
MONOBLOC 400 kg	MB400A..	280 mm
EVOLUTIVE 500 kg PF (with integrated storage box)	MBE500PFA..	400 mm
Pack EVO 800 kg PF (MBE500PF+MD300)	MBE5300PFB..	400 mm
Pack EVO 1100 Kg PF (MBE500PF+MD600)	MBE5600PFB..	400 mm
EVOLUTIVE 600 Kg	MBE600A..	310 mm
Pack EVO 900 Kg (MBE600+MD300)	MBE6300B..	310 mm
Pack EVO 1200 Kg (MBE600+MD600)	MBE6600B..	310 mm
EVOLUTIVE 900 Kg	MBE900A..	400 mm
Pack EVO 1200 Kg (MBE900+MD300)	MBE9300B..	400 mm
Pack EVO 1500 Kg (MBE900+MD600)	MBE9600B..	400 mm

EVOLUTIVE 900 Kg PF (with integrated storage box)	MBE900PFB..	550 mm
Pack EVO 1200 Kg PF (MBE900PF+MD300)	MBE9300PFB..	550 mm
Pack EVO 1500 Kg PF (MBE900PF+MD600)	MBE9600PFB..	550 mm
EVOLUTIVE 1200 Kg	MBE1200A..	480 mm
Pack EVO 1500 Kg (MBE1200+MD300)	MBE12300B..	480 mm
Pack EVO 1800 Kg (MBE1200+MD600)	MBE12600B..	480 mm
EVOLUTIVE 1400 Kg	MBE1400A..	550 mm
Pack EVO 1800 Kg (MBE1400+MD400)	MBE14400B..	550 mm
Pack EVO 2000 Kg (MBE1400+MD600)	MBE14600B..	550 mm
EVOLUTIVE 1800 Kg	MBE1800A..	600 mm
Pack EVO 2200 Kg (MBE1800+MD400)	MBE18400B..	600 mm
Pack EVO 2400 Kg (MBE1800+MD600)	MBE18600B..	600 mm

Cast iron ballast weights

Designations	Art. no.	Offset (Overhang)
MONOBLOC 850 Kg	B031108500	275 mm
MONOBLOC 1400 Kg	B031114000	375 mm
EVOLUTIVE weight 600 Kg BR (on lifting system)	E031106000	220 mm
EVOLUTIVE pack 1000 Kg BR (MMEVO600BR+MF400A)	E031110000	360 mm
EVOLUTIVE pack 1200 Kg BR (MMEVO600BR+MF600A)	E031120000	430 mm
EVOLUTIVE weight 600 Kg PM (On original ballast holder)	E031106000	300 mm
EVOLUTIVE pack 1000 Kg PM (MMEVO600PM+MF400A)	E031110000	440 mm
EVOLUTIVE pack 1200 Kg PM (MMEVO600PM+MF600A)	E031120000	510 mm

EVOLUTIVE weight 800 Kg (with integrated storage box)	E031108000	330 mm
EVOLUTIVE pack 1200 Kg (MMEVO800+MF400A)	E031112000	450 mm
EVOLUTIVE pack 1400 Kg (MMEVO800+MF600A)	E031114000	540 mm
EVOLUTIVE weight 1450 Kg (with integrated storage box)	E031114500	420 mm
EVOLUTIVE pack 1850 Kg (MMEVO1450+MF400B)	E031118500	540 mm
EVOLUTIVE pack 2050 Kg (MMEVO1450+MV600B)	E031120500	420 mm
EVOLUTIVE pack 2250 Kg (MMEVO1450+MF800B)	E031122500	570 mm
EVOLUTIVE pack 2450 Kg (MMEVO1450+MV600B+MF400B)	E031124500	540 mm
EVOLUTIVE pack 2850 Kg (MMEVO1450+MV600B+MF800B)	E031128500	570 mm

".." located in the ballast reference code: Ballast colour indication: "1" AGCO GREY, "2" CLAAS GREY, "3" JOHN DEERE GREEN, "4" BLACK, and "5" other colours.



Tel. +33 (0)5 82 81 97 50
lestagri.euromasse@gmail.com

euromasse.com
lestagri.fr

Your Lestagri - Euromasse partner